

1

2

3

4

5

6

7

8

Rev.	Description	Date	Drawn by	Checked by	Approved by
A	New Drawing	2006/11/22	Michael	Gavin	Stephen

A

A

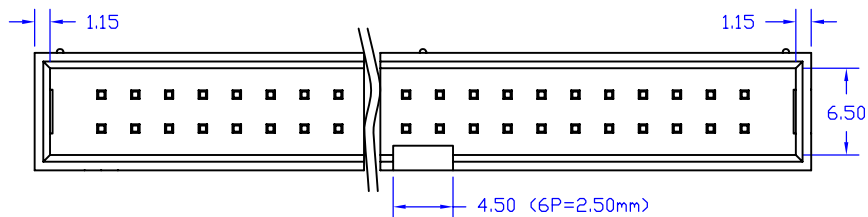

B

B

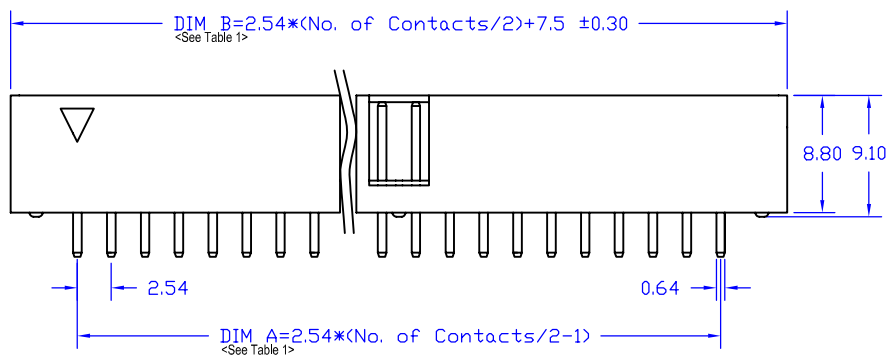

C

C

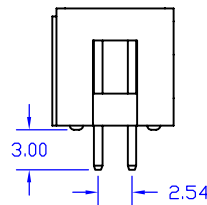

D

D

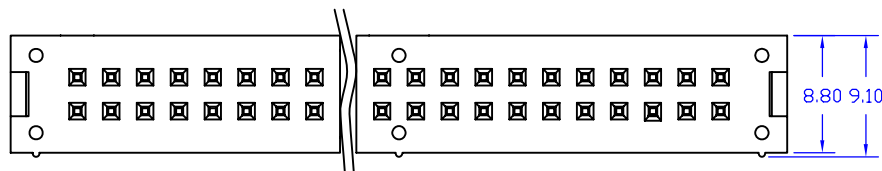

E

E

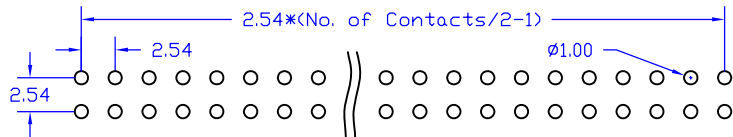

PCB Layout  
(Top View)

**NOTE:**

**Material and Finish:**

1. Housing: PBT (UL94V-0), Black.
2. Terminal: Copper Alloy, Gold Plating on Contact Area, Tin Plating on solder Tail.

**Electrical Characteristics:**

1. Current Rating: 3.0 Amp. Max..
2. Dielectric Withstand Voltage: 1000V AC RMS for 60Seconds.
3. Insulation Resistance: 5000M Ohms Min. at 500V DC.
4. Contact Resistance: 30m Ohms Max..

**Mechanical Characteristics:**

1. Operating Temperature: -40°C ~ +105°C
2. Contact Us for Customization.

**Table 1**

Part No.	Dimensions			Part No.	Dimensions		
	H=9.1mm	Pos.	A		H=9.1mm	Pos.	A
AESHEV04B-203F	6	5.08	8.37	AESHEV04B-218F	36	43.18	46.47
AESHEV04B-204F	8	7.62	10.91	AESHEV04B-219F	38	45.72	49.01
AESHEV04B-205F	10	10.16	13.45	AESHEV04B-220F	40	48.26	51.55
AESHEV04B-206F	12	12.70	15.99	AESHEV04B-221F	42	50.80	54.09
AESHEV04B-207F	14	15.24	18.53	AESHEV04B-222F	44	53.34	56.63
AESHEV04B-208F	16	17.78	21.07	AESHEV04B-223F	46	55.88	59.17
AESHEV04B-209F	18	20.32	23.61	AESHEV04B-224F	48	58.42	61.71
AESHEV04B-210F	20	22.86	26.15	AESHEV04B-225F	50	60.96	64.25
AESHEV04B-211F	22	25.40	28.69	AESHEV04B-226F	52	63.50	66.79
AESHEV04B-212F	24	27.94	31.23	AESHEV04B-227F	54	66.04	69.33
AESHEV04B-213F	26	30.48	33.77	AESHEV04B-228F	56	68.58	71.87
AESHEV04B-214F	28	33.02	36.31	AESHEV04B-229F	58	71.12	74.41
AESHEV04B-215F	30	35.56	38.85	AESHEV04B-230F	60	73.66	76.95
AESHEV04B-216F	32	38.10	41.39	AESHEV04B-231F	62	76.20	79.49
AESHEV04B-217F	34	40.64	43.93	AESHEV04B-232F	64	78.74	82.03

D

E

F

F

RoHS Compliant

Tolerance	0 ±0.20
	0.0 ±0.20
	0.00 ±0.20

Drawn By  
**Michael**

Checked By  
**Gavin**

Approved By  
**Stephen**

**AECONN**

Title  
**2.54mm Pitch, Shrouded Header,  
DIP Vertical, Dual, Female**

AECONN Technology Corp.

Drawing No. SH004-S-01  
Page 1/1

1

2

3

4

5

6

7

8