

1

2

3

4

5

6

7

8

Rev.	Description	Date	Drawn by	Checked by	Approved by
A	New Drawing	2006/11/06	Michael	Gavin	Stephen

A

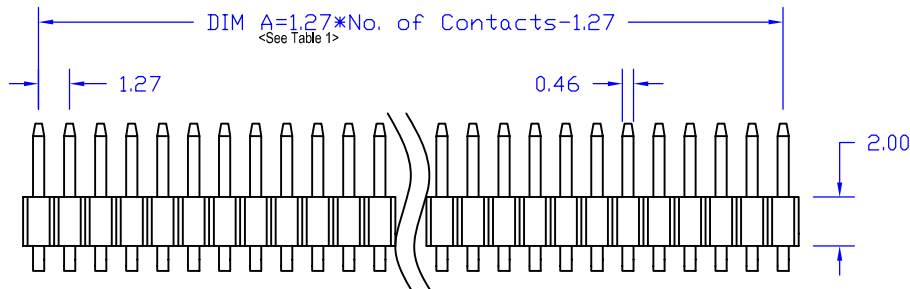

B

C

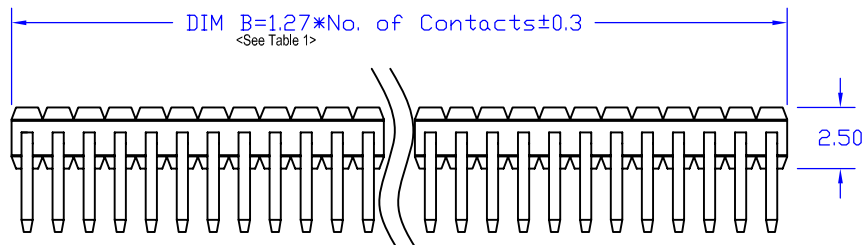

D

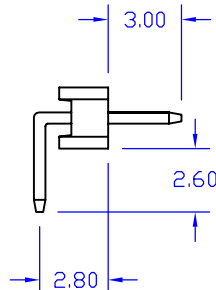

E

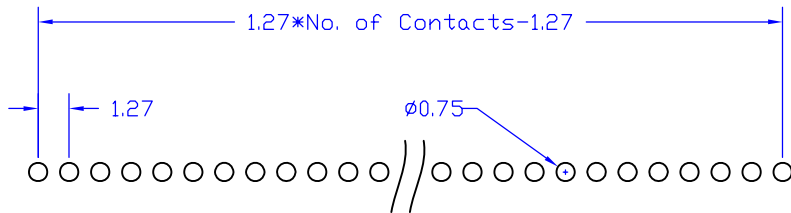

PCB Layout (Top View)

**NOTE:**

**Material and Finish:**

- 1. Housing: Polyester (UL94V-0), Black.
- 2. Terminal: Copper Alloy, Gold Plating Over All.

**Electrical Characteristics:**

- 1. Current Rating: 1.0 Amp. Max..
- 2. Dielectric Withstand Voltage: 500V AC RMS for 60Seconds.
- 3. Insulation Resistance: 5000M Ohms Min. at 500V DC.
- 4. Contact Resistance: 20m Ohms Max..

**Mechanical Characteristics:**

- 1. Operating Temperature: -40°C ~ +105°C
- 2. Contact Us for Customization.

Table 1

Part No.		Dimensions		Part No.		Dimensions	
H=2.0mm	Pos.	A	B	H=2.0mm	Pos.	A	B
AEPHBR01A-102L	2	1.27	2.54	AEPHBR01A-127L	27	33.02	34.29
AEPHBR01A-103L	3	2.54	3.81	AEPHBR01A-128L	28	34.29	35.56
AEPHBR01A-104L	4	3.81	5.08	AEPHBR01A-129L	29	35.56	36.83
AEPHBR01A-105L	5	5.08	6.35	AEPHBR01A-130L	30	36.83	38.10
AEPHBR01A-106L	6	6.35	7.62	AEPHBR01A-131L	31	38.10	39.37
AEPHBR01A-107L	7	7.62	8.89	AEPHBR01A-132L	32	39.37	40.64
AEPHBR01A-108L	8	8.89	10.16	AEPHBR01A-133L	33	40.64	41.91
AEPHBR01A-109L	9	10.16	11.43	AEPHBR01A-134L	34	41.91	43.18
AEPHBR01A-110L	10	11.43	12.70	AEPHBR01A-135L	35	43.18	44.45
AEPHBR01A-111L	11	12.70	13.97	AEPHBR01A-136L	36	44.45	45.72
AEPHBR01A-112L	12	13.97	15.24	AEPHBR01A-137L	37	45.72	46.99
AEPHBR01A-113L	13	15.24	16.51	AEPHBR01A-138L	38	46.99	48.26
AEPHBR01A-114L	14	16.51	17.78	AEPHBR01A-139L	39	48.26	49.53
AEPHBR01A-115L	15	17.78	19.05	AEPHBR01A-140L	40	49.53	50.80
AEPHBR01A-116L	16	19.05	20.32	AEPHBR01A-141L	41	50.80	52.07
AEPHBR01A-117L	17	20.32	21.59	AEPHBR01A-142L	42	52.07	53.34
AEPHBR01A-118L	18	21.59	22.86	AEPHBR01A-143L	43	53.34	54.61
AEPHBR01A-119L	19	22.86	24.13	AEPHBR01A-144L	44	54.61	55.88
AEPHBR01A-120L	20	24.13	25.40	AEPHBR01A-145L	45	55.88	57.15
AEPHBR01A-121L	21	25.40	26.67	AEPHBR01A-146L	46	57.15	58.42
AEPHBR01A-122L	22	26.67	27.94	AEPHBR01A-147L	47	58.42	59.69
AEPHBR01A-123L	23	27.94	29.21	AEPHBR01A-148L	48	59.69	60.96
AEPHBR01A-124L	24	29.21	30.48	AEPHBR01A-149L	49	60.96	62.23
AEPHBR01A-125L	25	30.48	31.75	AEPHBR01A-150L	50	62.23	63.50
AEPHBR01A-126L	26	31.75	33.02				

A

B

C

D

E

F



Tolerance	0 ±0.20 0.0 ±0.20 0.00 ±0.20	Drawn By <b>Michael</b>
		Checked By <b>Gavin</b>
		Approved By <b>Stephen</b>
Scale 1:1	Unit mm	

**AECONN**

**Title**  
**1.27mm Pitch, Post Header,  
DIP Right Angle, Single, Male**

AECOM Technology Corp.

Drawing No. PH001-S-01  
Page 1/1

1

2

3

4

5

6

7

8